

ES, ESO SERIES VALVES SINGLE MANIFOLDS

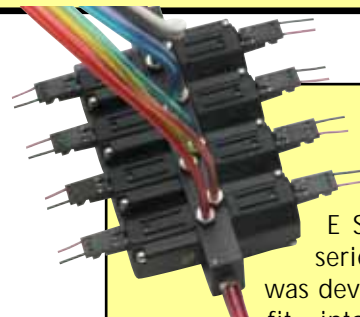

The ES/ESO series valve was developed to fit into tighter physical envelopes. By reducing the size of the base as well as the size of the coil, a considerable volume savings was achieved.

As in the case of the EV/EVO product, the ES/ESO uses the single moving part design proven many times in the EV/ET/EC series valves. Of course, given the reduced size of the coil the power to operate increases to 1 watt.

Because of its reliability, the ES/ESO series valve is found in many of the same applications and industries as its predecessor, the EV/ET/EC. However, the smaller size finds it used more commonly in portable or mobile equipment. This makes the valve particularly applicable in home healthcare applications.

26090-1



Single Station Side Port Manifold

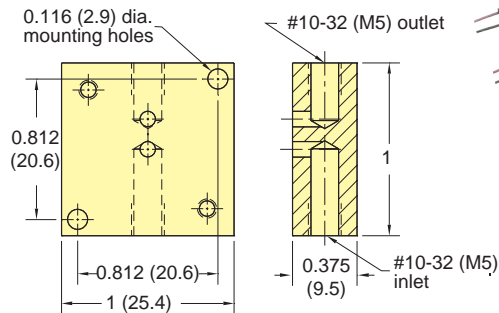

26090-2



Single Station Bottom Port Manifold

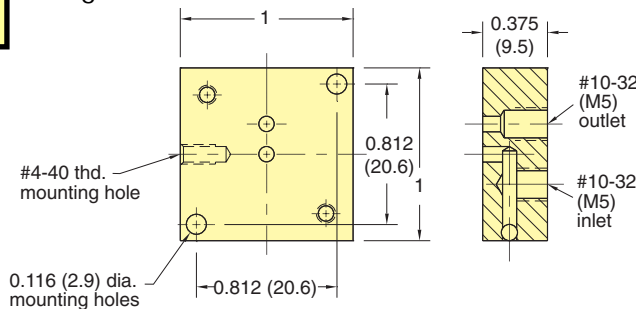

26090-3



Dual Station Manifold

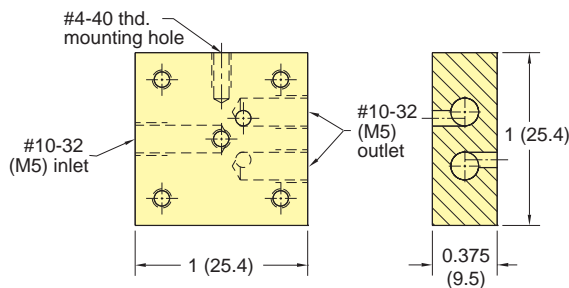

C3-RXB18



AMP Connector #103960-2 with 18" wire leads for ES/ESO valves

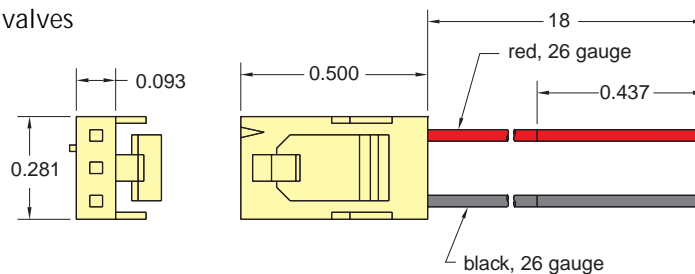

Lead Set Chart For ES Valve						
Part No.	Used On	Wire Colors			Lead Length	Wire Gage
		pin 1	pin 2	pin 3		
C3-RXB18	ES	red	~	black	18"	#26